

# TG-2022 SUPERBRAVA Electric stretcher



Maximum unassisted load	320Kg
Weight	78 Kg
Standards	UNE-EN-1865-2 UNE-EN-1865-3 EN-1789+A1 UNE-EN 60601-1 / UNE-EN 61000-6 UL-1642
Backrest Articulation/Shock Position	De 0° a 80°
Footrest Articulation/Shock Position	Double articulation
Wheels diameter	150 mm
Total Length <sup>1</sup>	2090 mm
Total Width	590 mm
Maximum and minimum height <sup>2</sup>	347 mm-1240 mm
Loading Height <sup>3</sup>	Máx. 1090 mm
Recommended operatives required to load / unload an occupied stretcher	1 operative, or 2 if the stretcher were occupied by a larger sized patient.
Recommended/Compatible fixation system	Rail SUPERBRAVO 1 and SUPERBRAVO 2

## 1. Installing the battery

The first step to work with the SUPERBRAVA is to place the 28V battery that powers the system. To do this we will place the battery in the connector incorporated in the stretcher.

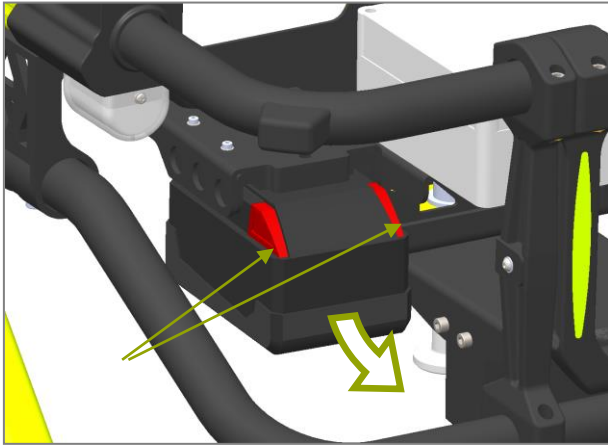

To remove the battery, simultaneously press the red buttons and pull to unclip the battery from its connector.

The autonomy of the battery in no-load mode (without charge) should be about 130 cycles.

If the battery becomes excessively discharged, it must be charged using the external battery charger. Do not attempt to charge the excessively discharged battery with the charging point of the Rail SUPERBRAVO.

The front part of the stretcher corresponds to the head part of the stretcher.

The battery is delivered with a minimum charge. Before operating the stretcher, the battery must be charged with the supplied charger until all the charge indicator LEDs are lit. After that you CAN work normally.

## 2. Starting and controlling the stretcher

To avoid possible injury to the patient and attendants in the event of an accident, do not place objects in the path of the moving parts of the stretcher. It is also advisable to avoid protruding elements inside the ambulance. The system starts up once the battery is connected to the stretcher and the power switch is turned on. The number of lit LEDs on the control unit will indicate the state of charge of the battery.

### *Functions of the buttons on the control panel*



**Yellow button:** by pressing it, the LEDs on the stretcher light up.

**Red button Right:** The stretcher unfolds to the end of the stroke. It will fully deploy with a single press until the end of the stroke if the stretcher is positioned on the rail. This cycle can be interrupted by touching any button.

**Red button Left:** The stretcher is folded to the end of the stroke. When the end of travel is reached, the Stretcher Fold position LED lights up. It will fold completely with a single push to the end of the stroke if the stretcher is positioned on the rail. This cycle can be interrupted by touching any button.

**Red Right + yellow button:** the stretcher folds out to its maximum height, ignoring the end of travel.

The stretcher goes into low power Stand-By mode if no button is pressed for 60 minutes. Simply press any button to switch the stretcher on again.

### Functions of the auxiliary control panel:



**Red button Right:** The stretcher unfolds to the end of travel. It will fully deploy with a single press to the end of travel if the stretcher is positioned on the rail. This cycle can be interrupted by touching any button.

**Red button Left:** The stretcher folds down to the end of the stroke. When the end of the stroke is reached, the Stretcher Fold position LED lights up. It will fold completely with a single push to the end of the stroke if the stretcher is positioned on the rail. This cycle can be interrupted by touching any button.

### 3. Adjustable reclining headrest

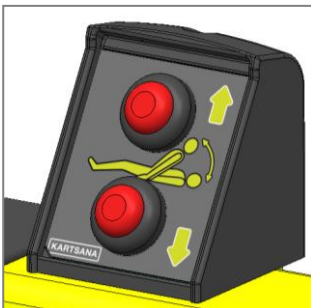

The movement of the headrest is controlled by the auxiliary control controls on the right and left side of the stretcher. The system allows the head to be positioned at the desired inclination.

**Top button:** Headrest UP button. Raises the head to the end of the stroke.

**Lower button:** DOWN button. Lowering of the head to the end of the stroke.

### 4. Extendable back rest frame

Before carrying out this action the back rest must be put at its most upright position.

To extract or fold up the telescopic back rest frame, you must pull one of the two red triggers located on each side of the stretcher. Stretching or pressing the back rest frame at the same time.

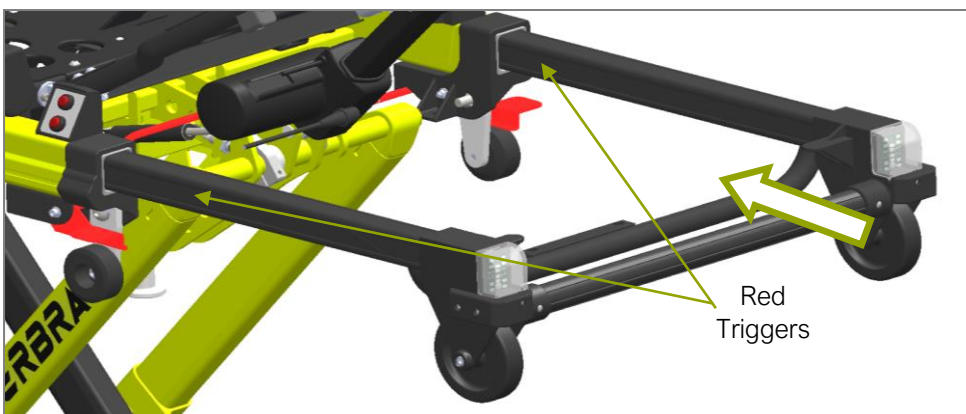

The head frame has a mechanical stop in the intermediate position (2090 mm long), one in the folded position (1723 mm) and one in the extended position (2210 mm). When the travel of the head frame reaches each

of these three positions, the red lever "clicks" back into its original position.

It is important that when the stretcher is inserted into the Superbravo rail, the position of the front frame is intermediate. If it is in the extended or folded position it could cause damage to the stretcher and/or the operator.

## 5. Adjustable leg and footrest:

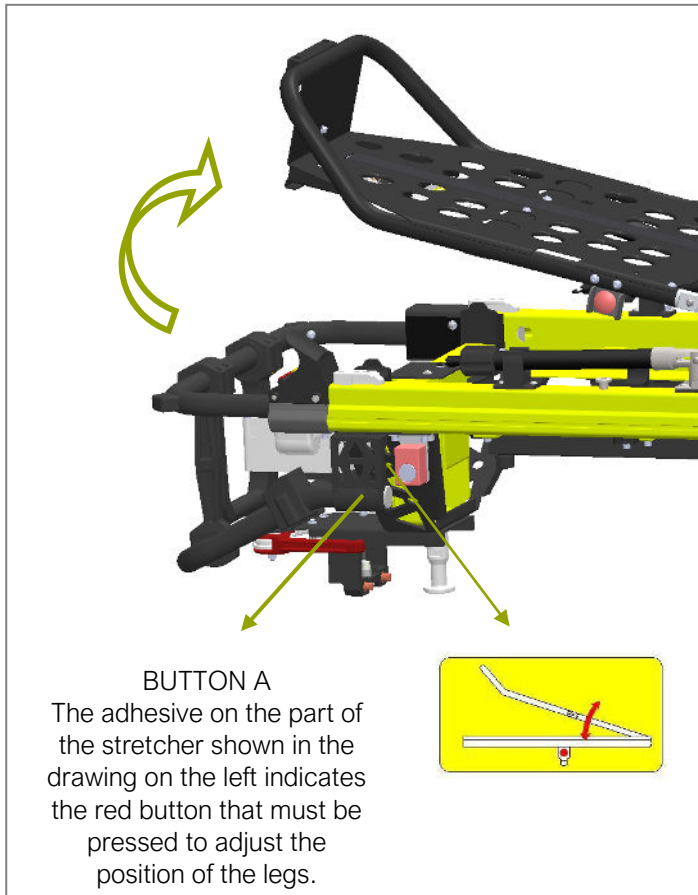

### *Button for adjusting the leg inclination:*

The required inclination of the leg rest can be obtained by pressing button A and moving the leg rest manually. Once the correct inclination has been reached, release button A to automatically lock the leg rest.

### *Button for adjusting the foot inclination:*

Press button B to change the feet inclination to the required position without changing the inclination of the legs, moving it only in the direction shown in the figure below until the required inclination is obtained.

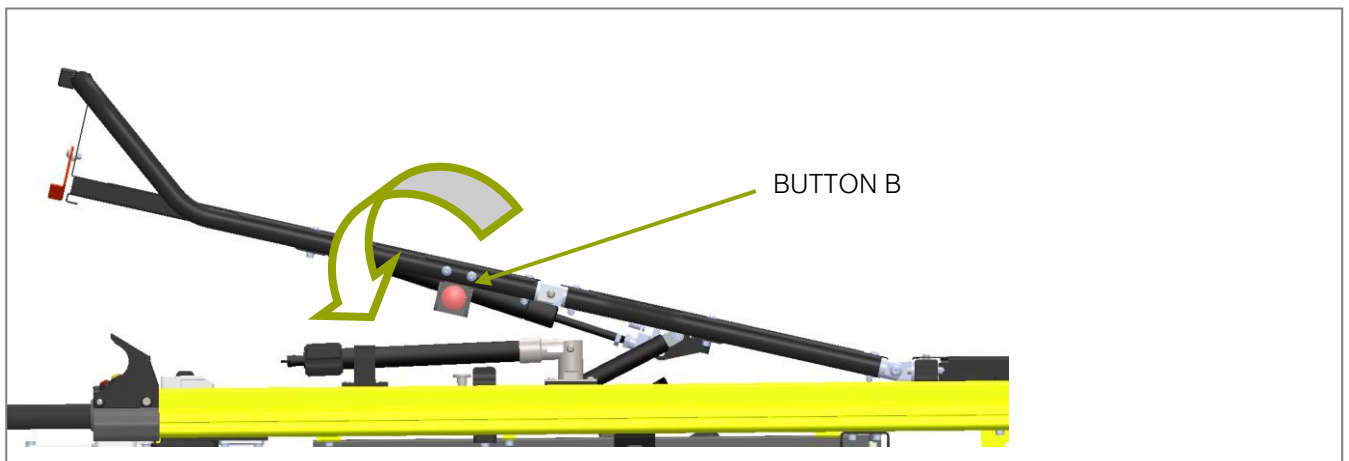

## 6. Guardrails

The safety rails can be adjusted from a fully horizontal position to a 90-degree position. The system allows the guardrail to be fixed in the 5 intermediate positions. The upward movement from the horizontal position to the 90° position is carried out manually. Once the desired position is reached, the position of the railing is automatically fixed.

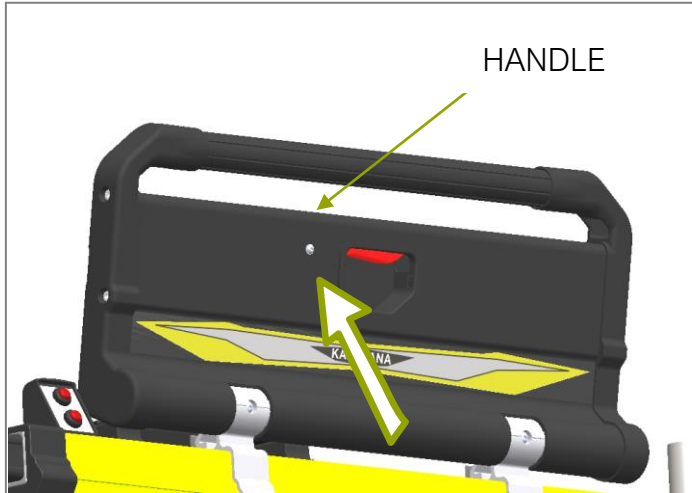

To unlock the system, the red handles must be pressed, releasing the system, and the handrails can be moved manually towards the outside of the stretcher.

## 7. IV Poles

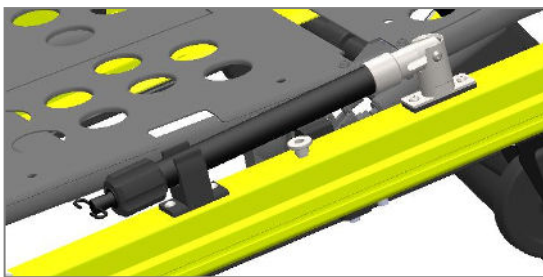

The stretcher is equipped with two I.V. holders on both sides of the SUPERBRAVA stretcher. The IV pole is raised to its vertical position so that it can be fixed perpendicularly to the stretcher.

The length of the IV pole can be lengthened or shortened by unscrewing the fixings on the telescopic rod. Lift the hook to the desired

position and screw the attachment back on. The maximum permissible load of the whey pole is 6 kg.

## 8. Rear wheel brake lever



Activate the lever with your foot to enable the brake to lock the rear wheels. This lever locks both the lengthways and revolving movement of the trolley.

## 9. Lever to unlock revolving front wheels

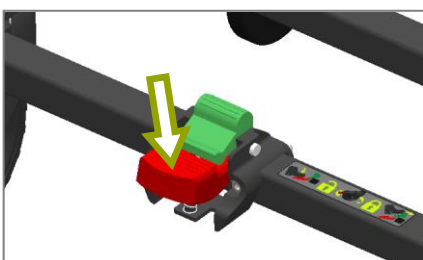

Pressing the red centre lever allows the wheels to turn freely. Pressing the green rear lever blocks the free rotation of the wheels.



## 10. Emergency lever

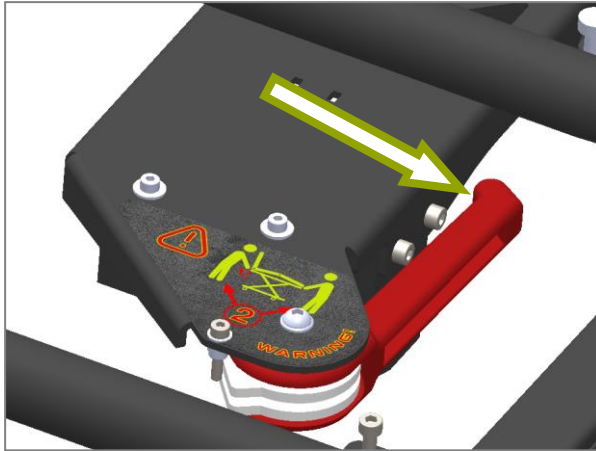

In the event of a malfunction of the hydraulic system, the stretcher can be operated manually. For the following procedure, it is essential that the stretcher is handled by two operators. With the stretcher in the unfolded position, pull the red trigger located next to the battery at the rear of the stretcher. The stretcher will lower to the lower stop and remain in this position.

In the same way, by pressing the trigger and lifting the stretcher (always between the two operators), the stretcher legs unfold until the trigger is released and the stretcher is fixed in the adopted position.

If you wish to load the rail, you must position it on top of the block (as in the normal procedure) and fold the stretcher manually by pushing the handles located on the lower part of the chassis.

To insert the rail into the ambulance, the folded position of the stretcher must be held manually until the rail is secured.

