

DATA SHEET

SUPERBRAVA Accessories

SUPERBRAVA

ELECTRIC EQUIPMENT

Bariatric kit

Widening accessory for transporting bulky patients. Its "click" system allows instant installation and thanks to the coloured parts to identify both sides, it is very intuitive. Supplied with belts, side cushions and carrying bag.



Ref	Description
C-094	Bariatric kit

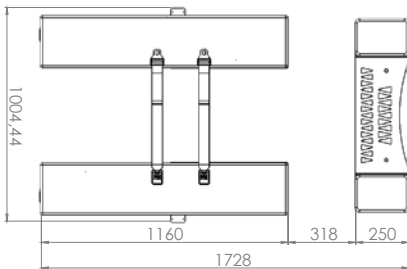

Extendable headrest

Comfortable extendable head up to a total of 157 mm. With stops on both sides for greater safety. It can be folded down, making it easier to clean the mattress or change the sheet.



Anatomical ear cushion to be installed directly on the mattress.

Ref	Description
C-098	Extensible headrest
C-099	Anatomical pillow

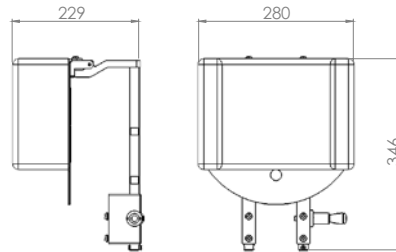

Oxygen bottle holder

Easy to install oxygen bottle holder for both the front and the back of the stretcher. Bottle capacity: 2 litres



Ref	Description
C-095	Soporte botella de oxígeno

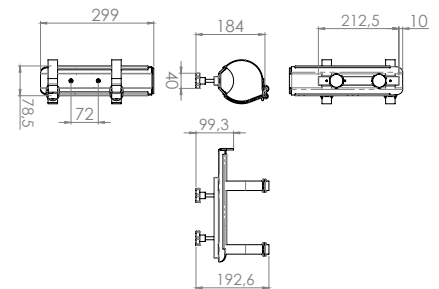

Utensil tray

High-strength aluminium tray designed to hold small medical equipment, working tools and patient's personal belongings.



Ref	Description
C-093	Utensil tray

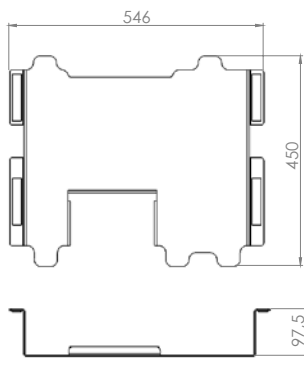

Attachment for Corpuls equipment

Designed to Corpuls specifications. Easy installation, both on the side profiles and on the front of the stretcher.



Ref	Description
C-040	Attachment for Corpuls equipment

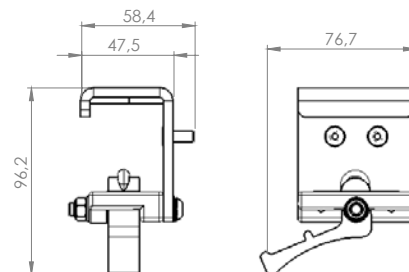

Instrument table

Allows the attachment of various medical devices. It is placed on the side frames with a simple click. With straps for securing instruments and folding legs for easy storage.



Ref	Description
C-097	Instrument table

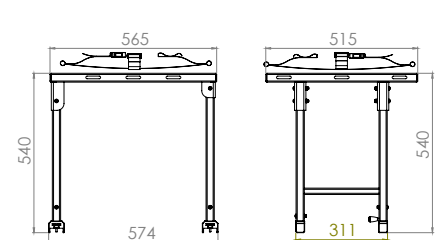

KARTSANA

Life-moving innovation

Narcís Monturiol, 34
08192 - Sant Quirze del Vallès
Barcelona (Spain)

T.: +34 93 715 86 72
info@kartsana.com
www.kartsana.com



Pushing poles

Facilitate the transfer of the stretcher when it is not fully raised. The poles are telescopic and are located on both sides of the stretcher at the rear. Easy assembly with only 4 screws. Installation kit included.



Ref	Description
C-092	Pushing poles

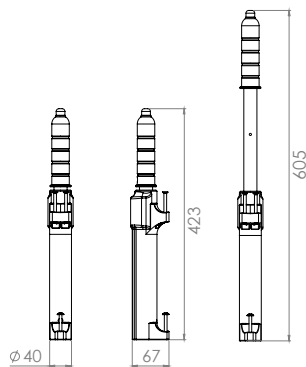

Accessories bag

Bag for storing accessories and personal items. Can be clipped to the backrest of the stretcher.



Ref	Description
C-091	Accessories bag

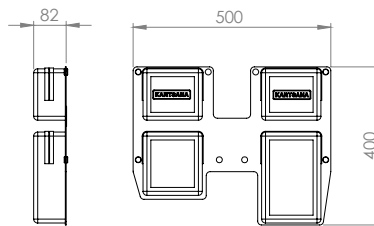

Paediatric mattress

Multi-purpose mattress with an adaptor with its own safety belts for children weighing between 3.5 and 11 kgs.



Ref	Description
P-105	Paediatric mattress

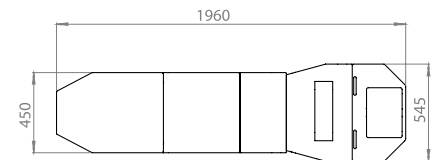

Heated mattress

Heated mattress that provides the patient with the ideal temperature, guaranteeing comfort throughout the transfer. The battery is removable. It is purchased separately as well as the charger.



Ref	Description
P-107	Heated mattress
07-150-001	Battery
07-151-001	Battery charger

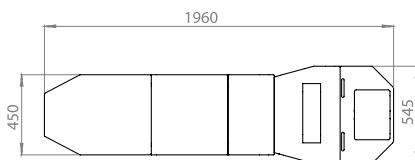

Battery

Milwaukee M28 battery with high capacity and easy installation.



Ref	Description
07-0110-001	Battery

Battery charger

Allows the battery to be charged from a conventional 230V wall socket. European power supply.



Ref	Description
07-0112-001	Battery charger